

# ELECTRICAL PLAN — SAMPLE APARTMENT UNIT

Bedroom • Bathroom • Kitchenette | Reference / Permit Submittal Example | NEC 2023

WireGenie by SparkPlan

Sheet E1.0 • Scale: 1/4" = 1'-0" • Drawn: WG  
Project: 123 Example St • Rev: 0

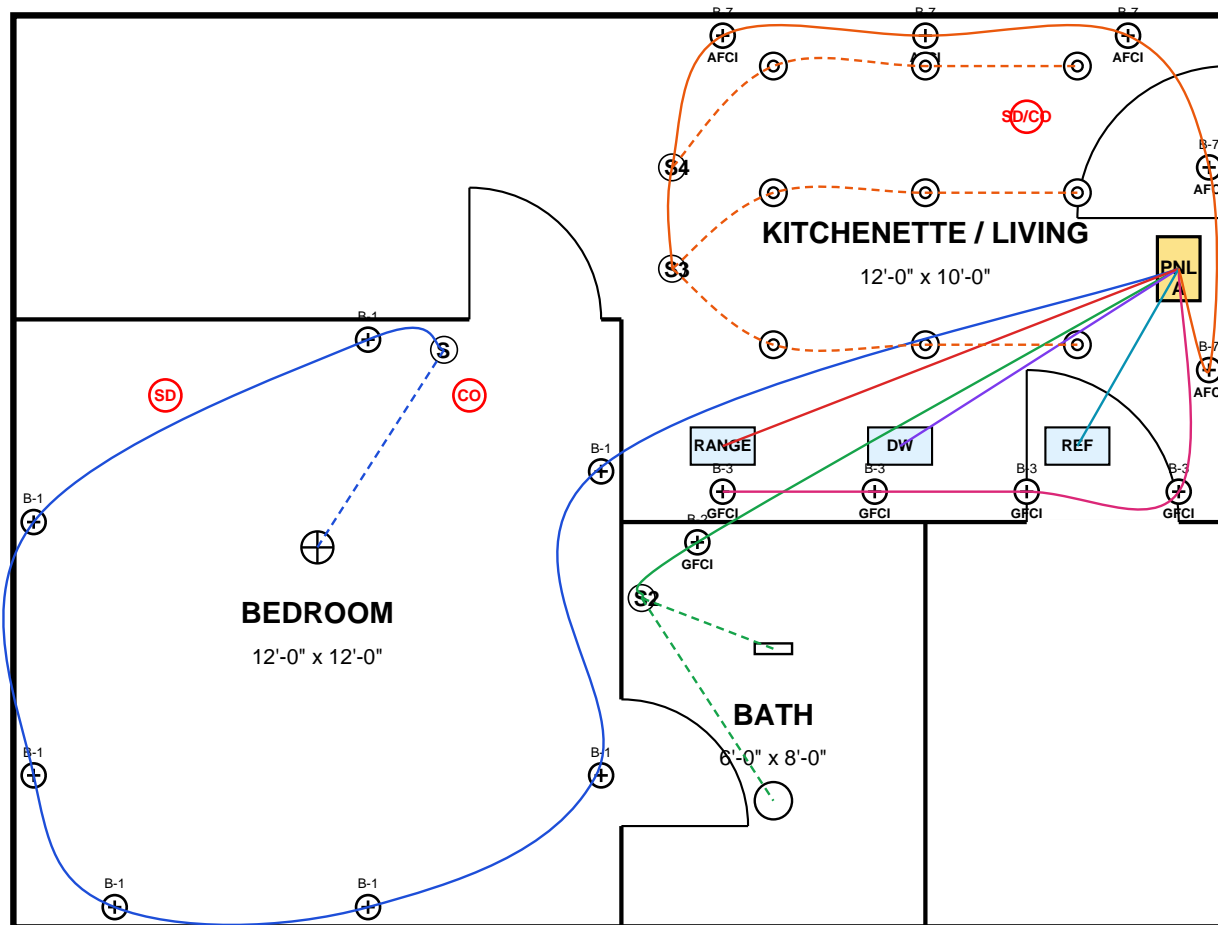

## LEGEND

- Duplex Receptacle, 15A/20A
- GFCI Receptacle
- AFCI-protected Receptacle
- Wall Switch (S, S2 = 2-way)
- Ceiling Luminaire
- Recessed Can (4" LED)
- Vanity Light
- Bath Exhaust Fan w/ Light
- Smoke Detector / CO
- Load Center / Panel
- Circuit run (color = circuit #)
- Switch leg to luminaire (dashed)

## PANEL A — 100A, 120/240V, 1Ø

CKT	DESCRIPTION	WIRE	BRK
B-1	Bedroom Recep + Lights (AFCI)	12-2	20A
B-2	Bath Recep (GFCI)	12-2	20A
B-3	Kitchen SAC #1 (GFCI)	12-2	20A
B-4	Kitchen SAC #2 / DW	12-2	20A
B-5	Range	6-3	40A/2P
B-6	Refrigerator	12-2	20A
B-7	Living Recep + Lights (AFCI)	12-2	20A
B-8	Bath Fan / Vanity Lights	14-2	15A
B-9	Smoke/CO (interconnected)	14-3	15A
B-10	Spare	—	20A

## GENERAL NOTES

- All work shall comply with NEC 2023 and local amendments.
- AFCI protection per 210.12 for all 120V 15/20A circuits in dwelling areas (bedrooms, living, etc.).
- GFCI protection per 210.8 in bath, kitchen counter, within 6 ft of sinks, and any outdoor receptacles.